



COGIROLL

Switch rail displacement assistance device

COGIROLL

The COGIROLL system is a roller device for switch assistance operation, suitable for all types of switch blades. It can be assembled on a turnout in operation, without removing slidechairs and without modification of existing parts.

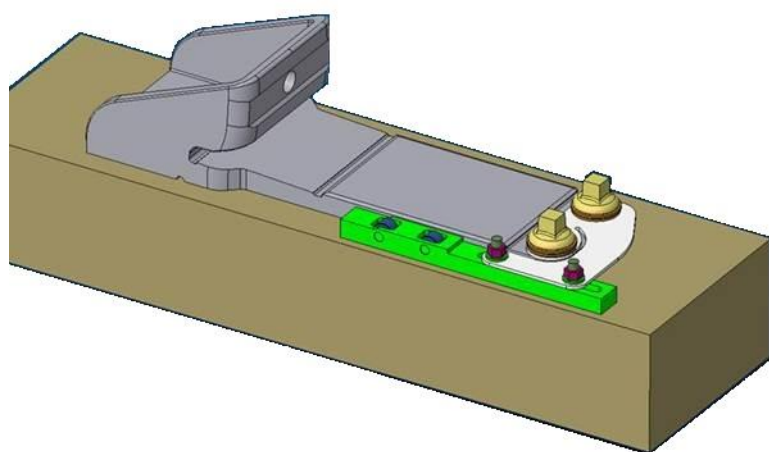
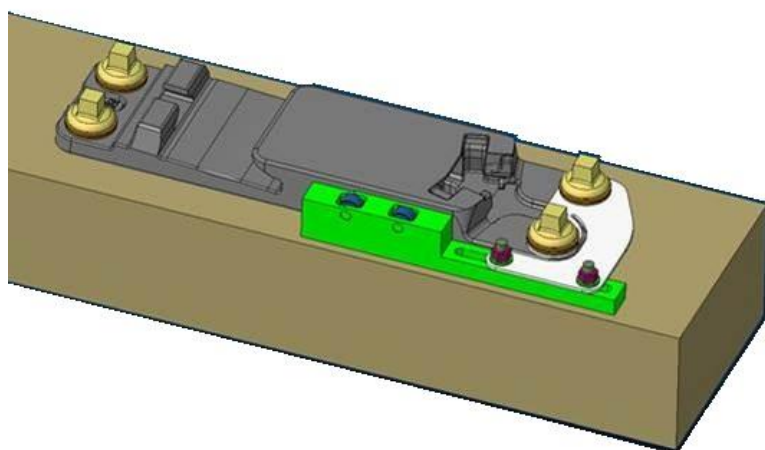

The system is designed to be installed on all types of supports: concrete sleepers, wooden sleepers, composite sleepers, slab...

Characteristics

- ▶ Use on all types of switch rails
- ▶ Rollers treated : 60 HRc
- ▶ High performance stainless steel axle
- ▶ **Maintenance free**

AVANTAGES

- ▶ Lubrication free
- ▶ Reduction of driving loads
- ▶ Interchangeable with existing parts
- ▶ Easy and fast installation
- ▶ Adaptable on existing installations
- ▶ Will not go over the sleeper or direct fastened on slab
- ▶ Suitable for all types of sleepers and switch blades
- ▶ Laid vertically or with a cant
- ▶ Reliability: 1 million operation